

TWO-WAY LARGE (VL-3009)

Up & down bracket lights for LED lamps (E-27)

Beam angle	Symmetrical
Luminous flux [lm]	2,240[lm] ~ 2,400 [lm]
Protection Class	IP65
Certification	KS C 7713 (LED 경관등)



Description

가장 기본이 되는 벽부등 중에 하나인 TWO-WAY LARGE는 기존 광원 PAR38 120W X 2를 LED 20W X 2로 대체가 가능하며 84%의 에너지 절약 효과가 있다. 또한 조명기구 내부에 고조도 반사판을 적용하여 조도보완과 은은하게 퍼지는 조명의 효과가 건축물의 윤곽선을 도드라지게 하는 효과를 연출한다. 온도와 습기에 취약한 엘이디 소자의 특성을 고려하여 완벽한 방열, 방습구조를 갖춘 TWO-WAY LARGE는 빛의 효과를 상쇄시키지 않도록 조화와 균형, 내구성을 충분히 고려하여 디자인한 조명기구이다.

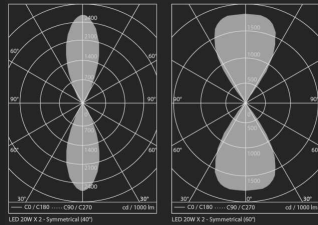

CE MARKED
RoHS RECYCLED
4.2kg

MODEL	CODE NO.	LAMP	BASE	INPUT	lm/cd
TWO-WAY LARGE (투웨이라지)	3009-L32	LED PAR38 18W X 2	E-27	AC 220V	2,400[lm]
	3009-L40	LED PAR30 20W X 2	E-27	AC 220V	2,240[lm]

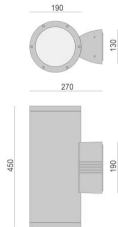

Materials :	Body_ aluminum die casting. Reflector_ high grade angulate aluminum. Diffuser_ 8mm toughened clear tempered glass. Cover frame_ aluminum die casting. Housing box_ aluminum die casting. Attach bracket_ aluminum die casting. Gasket and seals_ silicone rubber. Fixings_ stainless steel screws.
Finishing :	Mechanical and chemical anti-corrosion treatment; AKZONOBEL, Polyester, UV resistant, exterior paint system, thermally cured at 200 °C
Adjustment :	Fixed lighting fixture
Paint Color :	Gray painted (Standard) / Another paint color on request
Power :	Electronic power supply unite included
Input Voltage :	AC 220~240V 60Hz
Option :	Cable lengths on request

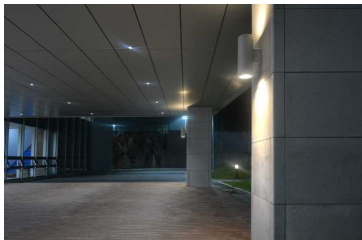

대구, 한국가스공사

Energy Saving
84%
LED par30 20W x 2 vs Par38 120W x 2